

H2O DIRECT CATALOGUE

More than just water...



TABLE OF CONTENT

OUR HISTORY + MICROFILTER

OUR ENVIRONMENT

Scale Reduction
Filters

IEN

VH-IEN

Premium Water
Filters

FX

HF2

Water
Filters

MH4

M9

K3

FITTINGS

SERVICE + INSTALLATION

UK Customer Locations

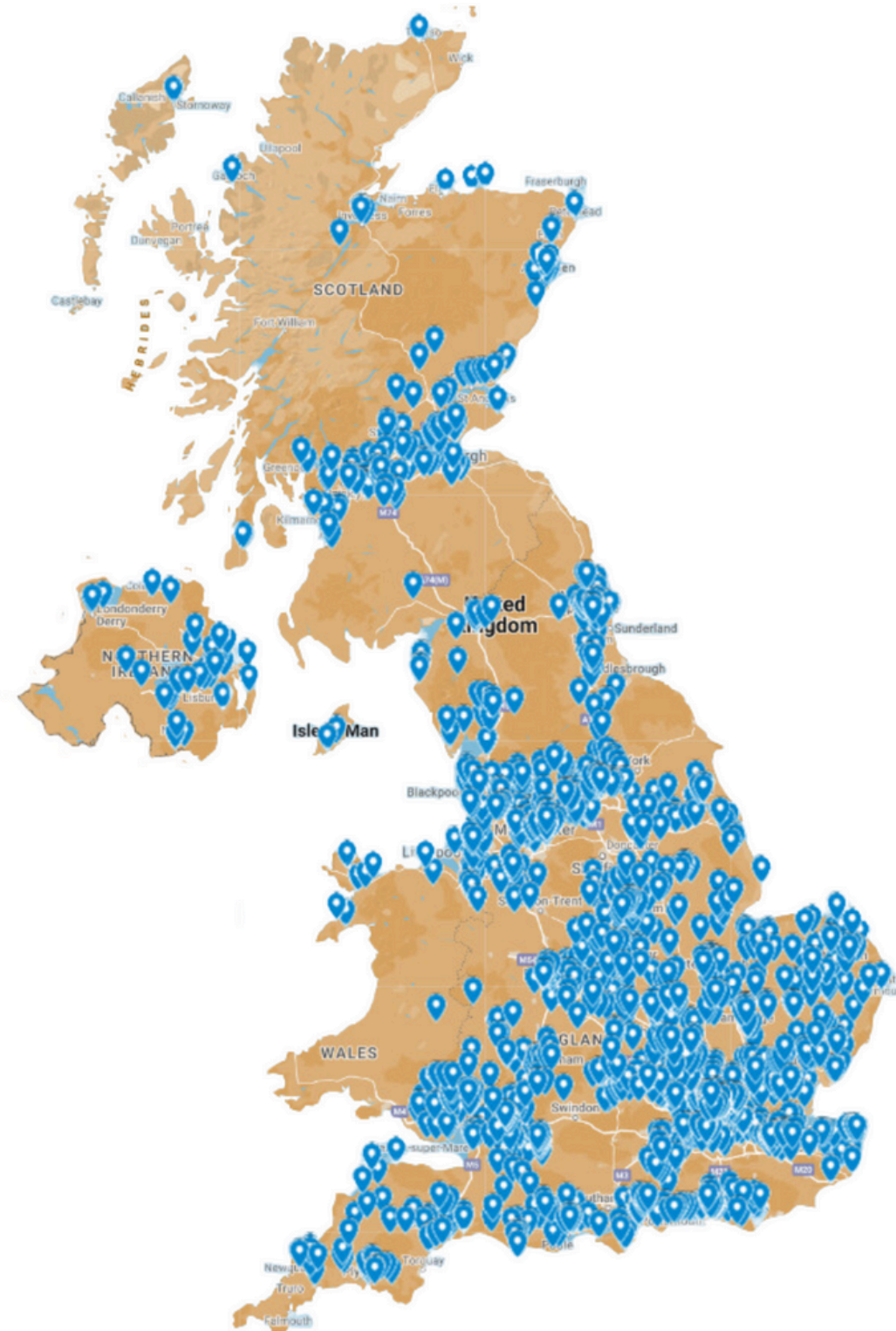

*May represent multiple customers in one location

OUR HISTORY AND MICROFILTER

H2O Direct Ltd are experts in water filtration products for the Coffee, Vending and Point of Use (POU) water cooler industries. We specialise in a wide range of water filters and fittings for use on Coffee and Vending machines, Hot Water Boilers and Water Coolers and operate in the U.K. and Europe.

Our partner, Microfilter, is an award winning filter manufacturer in Korea. It was established in 1966 and is a world class filtration company that seeks to create value for customers and their environment. They have manufactured and distributed premium residential and commercial water filtration products.

OUR ENVIRONMENT



Recycling since 2017, H2O Direct offers their customers the ability to recycle the IEN and VH-IEN models of their filters. The useful components within the filter that can be reused are separated and the remaining plastic is ground up and turned into pellets ready for recycling into other products.

The capability to recycle water filters is fundamental to helping reduce plastic waste with 98% of materials recycled which generates a saving of over 120 tonne of would be used CO2 and 6.7 million plastic cups equivalent.

The facility to recycle the filters also offers H2O Directs' clients the opportunity to deliver a strong message to their own customers that they are committed to an industry wide pledge to reduce plastic waste through the supply of H2O Direct water filters.

H2O have partnered up with Ecologi, an Environmental organization, who are focused on planting trees and funding the world's best carbon offsetting solutions on a worldwide basis.



IEN

- Fixed 30% bypass
- High level of scale reduction
- Mixed blend of ION exchange resin
- Filters bad taste/odour/chlorine

Code	Type	Micron	Capacity Ltr	Connection	Scale Reduction
IEN-1500R-001	Replacement	1	1,533	3/8" Push fit	✓
IEN-3000R-001	Replacement	1	3,006	3/8" Push fit	✓
IEN-6000R-001	Replacement	1	6,005	3/8" Push fit	✓
IEN-9000R-001	Replacement	1	9,000	3/8" Push fit	✓

*Recycling available

*Heads supplied seperately



VH-IEN

- Variable 0-70% bypass
- High level of scale reduction
- Mixed blend of ION exchange resin
- Filters bad taste/odour/chlorine
- For Steam / Combi ovens
- Variable 0-10% bypass
- High level of scale reduction
- Service system available

Code	Type	Micron	Capacity Ltr	Connection	Scale Reduction
VH-IEN-1500R-01	Replacement	1	1,884	3/8" Push fit	✓
VH-IEN-3000R-01	Replacement	1	3,694	3/8" Push fit	✓
VH-IEN-6000R-01	Replacement	1	7,031	3/8" Push fit	✓
VH-IEN-9000R-01	Replacement	1	11,062	3/8" Push fit	✓

*Recycling available

*Heads supplied seperately



FX

- Eliminates bacteria, THM'S & micro plastics more than 0.1 micron
- High Capacity
- High Flow
- EP Compatible Cartridge

Code	Type	Micron	Capacity Ltr	Connection
HF-FX10-EP-001	Replacement	0.1	30,000	3/8" Push fit
HF-FX15-EP-001	Replacement	0.1	60,567	3/8" Push fit
HF-FX15S-EP-001	Replacement	0.1	60,567	3/8" Push fit
HF-FX17-EP-001	Replacement	0.1	72,000	3/8" Push fit

*Heads supplied seperately



HF2

- Scale and Corrosion Protection
- Removes 6 Heavy Metals
- Removes 28 Hazardous Chemicals
- >95% Microplastic Reduction
- >92% Chlorine Reduction
- EP Compatible Cartridge

Code	Type	Micron	Capacity Ltr	Connection
HF2-10S-001	Replacement	0.5	45,425	3/8" Push fit
HF2-15S-001	Replacement	0.5	79,494	3/8" Push fit
HF2-17S-001	Replacement	0.5	98,421	3/8" Push fit



HF2-10S

HF2-15S

HF2-17S

MH4

- Hi Flow
- 3/8" Push Fit Connections
- Scale Inhibitor (MH4P)
- Auto Water Shut Off
- Quick Change
- Chlorine Reduction

Code	Type	Micron	Capacity Ltr	Connection
MH4R-001	Replacement	1	10,000	3/8" Push fit

*Heads supplied seperately



M9

- Integral Hinged Mounting Bracket
- Auto Water Shut Off Valve
- 1/4" Pushfit Connections
- Scale Inhibitor (M9MP)
- Chlorine Reduction
- Sediment Filtration
- Taste & Odour

Code	Type	Micron	Capacity Ltr	Connection
M9MR-001	Replacement	1	5,678	1/4" Push fit
M9MPR-001	Replacement	1	5,678	1/4" Push fit



M9M

M9MP

K3

- 1/4" Pushfit Connections
- Scale Inhibitor (K3P)
- GAC (K3G)
- Chlorine Reduction
- Sediment Filtration
- Taste & Odour

Code	Type	Micron	Capacity Ltr	Connection
K3-001	Inline	1	3,785	1/4" Push fit
K3P-001	Inline	1	3,785	1/4" Push fit
K3G-001	Inline	1	3,785	1/4" Push fit



FITTINGS

Male Straight Adapter



MCM – 1/4" PF x 1/4" BSPT
Product Code: MBA1414G01

MCM – 5/16" PF x 3/8" BSPT
Product Code: MBA5138G01



John Guest – 1/4" PF x 1/4" BSP
Product Code: PI010812S



1/4" PF x 3/4" BSP
Product Code: ABB728



DMFit – 1/4" PF x 3/4" BSPP
Product Code: AMCB0409S



John Guest – 3/8" Push Fit x 1/2" NPTF
Product Code: PI011224S



DMFit – 3/8" PF x 3/8" BSPP
Product Code: AMCB0606

MCM – 1/4" PF x 1/4" NPTF
Product Code: MAA1414G01

MCM – 3/8" PF x 1/2" NPTF
Product Code: MAA3812G01

John Guest – 3/8" PF x 3/8" BSP
Product Code: PI011213S

3/8" PF x 3/4" BSP
Product Code: ABB893

DMFit – 3/8" PF x 3/4" BSPP
Product Code: AMCB0609S

John Guest – 3/8" PF x 3/8" BSPT
Product Code: PI011203S

MCM – 1/4" PF x 1/2" BSPT
Product Code: MAA1412G02

MCM – 3/8" PF x 3/8" BSPT
Product Code: MAA3838G02

MCM – 1/4" PF x 1/2" NPTF
Product Code: MAA1412G01

MCM – 3/8" PF x 3/8" NPTF
Product Code: MAA3838G01

Shut Off Valves



MCM – 1/4" Shut off Valve (Single Lever)
Product Code: HVA1414W01-S



DMFit – 1/4" PF x 1/4" PF Shut off Valve
Product Code: AHUC0404W



JG 1/4" PF x 1/4" NPFT Male Shut off Valve
Product Code: PPSV010822W



JG 3/8" PF Shut off Valve
Product Code: PPSV041212W

DMFit – 3/8" PF x 3/8" PF Shut off Valve
Product Code: AHUC0606W

Female Straight Adapter



MCM – 1/4" PF x 7/16" UNS
Product Code: FAA1471G01
MCM – 1/4" PF x 1/4" NPTF
Product Code: FAA1414G01



MCM – 1/4" PF x 1/2" (BSPP)
Product Code: FAA1412G01
MCM – 1/4" PF x 3/4" (G-Packing)
Product Code: FAA1434G01
MCM – 5/16" PF x 1/2" (BSPP)
Product Code: FAA5112G01



John Guest – 1/4" PF x 3/4" BSP
Product Code: CI320816FS
John Guest – 1/4" PF x 1/2" BSP
Product Code: CI320814FS
John Guest – 3/8" PF x 1/2" BSP
Product Code: CI321214FS
John Guest – 3/8" PF x 3/4" BSP
Product Code: CI321216FS



MCM – 1/4" PF x 3/4" (BSP) (Brass)
Product Code: FAB1434G01



DMFit – 3/8" PF x 1/2" BSPP
Product Code: AFAB0607C



DMFit – 3/8" PF x 3/8" BSPP
Product Code: AFAB0606C
DMFit – 3/8" PF x 3/4" BSPP
Product Code: AFAB0609FP



John Guest – 3/8" PF x 3/8" BSP
Product Code: PI451213FS

Equal Tee



MCM – 1/4" Push Fit
Product Code: TEA1414G01

MCM – 5/16" Push Fit
Product Code: TEA5151G01

MCM – 3/8" Push Fit
Product Code: TEA3838G01

Equal Elbow



MCM – 1/4" x 1/4" Push Fit
Product Code: LEA1414G01

MCM – 5/16" x 5/16" Push Fit
Product Code: LEA5151G01

MCM – 3/8" x 3/8" Push Fit
Product Code: SEA3838G01

Equal Straight



MCM – 1/4" x 1/4" Push Fit
Product Code: SEA1414G01

MCM – 5/16" x 5/16" Push Fit
Product Code: SEA5151G01

MCM – 3/8" x 3/8" Push Fit
Product Code: SEA3838G01

FITTINGS

Stem Adapter



1/4" Stem x 3/8" PF (Straight)
Product Code: ABB1729

1/4" Stem x 15mm PF (Straight)
Product Code: ABB1628



1/4" Stem x 3/4" BSP (Female)
Product Code: PBQRC-005



1/4" Stem x 3/4" BSP (Male)
Product Code: PBQRC-003



DMFit - 3/8" Stem x 3/8" BSP (Male Adapter)
Product Code: ASAB0606



John Guest - 3/8" Stem x 3/8" BSP (Male)
Product Code: PI051213S



3/8" Stem x 3/4" BSP (Male)
Product Code: PBQRC-001

Stem Enlarger (Straight)



DMFit - 5/16" Stem x 3/8" PF
Product Code: AEL0605

Stem Reducing (Elbow)



MCM - 1/4" Stem x 1/4" Push Fit
Product Code: LSA1414G01

MCM - 5/16" Stem x 5/16" Push Fit
Product Code: LSA5151G01

MCM - 3/8" Stem x 1/4" Push Fit
Product Code: LSA3814G01

MCM - 3/8" Stem x 5/16" Push Fit
Product Code: LSA3851G01

MCM - 3/8" Stem x 3/8" Push Fit
Product Code: LSA3838G01



DMFit - 3/8" Stem x 5/16" Push Fit
Product Code: ATEU0506



MCM - 5/16" Stem x 1/4" Push Fit
Product Code: RDA5114G01

MCM - 3/8" Stem x 1/4" Push Fit
Product Code: RDA3814G01



DMFit - 3/8" Stem x 1/4" Push Fit
Product Code: ARD0406

Reducing Straight



MCM - 5/16" x 1/4" Push Fit
Product Code: SRA5114G01

MCM - 3/8" x 1/4" Push Fit
Product Code: SRA3814G01

MCM - 3/8" x 5/16" Push Fit
Product Code: SRA3851G01



John Guest - 5/16" x 1/4" Push Fit
Product Code: PI201008S

Reducing Elbow



MCM - 5/16" x 1/4" Push Fit
Product Code: LRA5114G01

MCM - 3/8" x 1/4" Push Fit
Product Code: LRA3814G01

MCM - 3/8" x 5/16" Push Fit
Product Code: LRA3851G01

Reducing Tee



MCM - 1/4" x 5/16" x 1/4" Push Fit
Product Code: TRA5114G01

MCM - 5/16" x 1/4" x 5/16" Push Fit
Product Code: TRA1451G01

MCM - 3/8" x 1/4" x 3/8" Push Fit
Product Code: TRA3814G01

Stem Reducing (Straight)

Check Valve (Straight)



MCM - 1/4" x 1/4" Push Fit Check Valve
Product Code: SCA1414G21

MCM - 5/16" x 1/4" Push Fit Check Valve
Product Code: SCA5114G01

MCM - 5/16" x 5/16" Push Fit Check Valve
Product Code: SCA5151G01



DMFit - 3/8" x 3/8" Push Fit Check Valve
Product Code: ACHV0606W

Pressure Limiting Valve



1/4" Push Fit PLV
Product Code: ZLVFPV0104-60

3/8" Push Fit PLV
Product Code: ZLVFPV0308-60



MCM - PLV 350 1/4" x 1/4" Push Fit
Product Code: PLA1414G21

Two-Way Divider



MCM - 1/4" Push Fit
Product Code: DTA1414G01

MCM - 3/8" Push Fit
Product Code: DTA3838G01

Water Block and Reset Adapter



Water Block 3/4" BSP Leak / Flood Protection Valve
Product Code: WB-001



Water Block Reset Adaptor
Product Code: WBR-001

FITTINGS

Appliance Fittings



DMFIT - 15MM PF (EQUAL TEE) X 3/4" BSP (MALE)
Product Code: THVTU1509M-BG



DMFit 15mm PF x 3/4 inch BSP (Male)
Product Code: AHVMCB1509M



John Guest - 15mm Speedfit (Equal Tee) (White)
Product Code: PEM0215W



Washing Machine Y Piece 3/4" BSP
Product Code: WMY-001



15mm x 3/4" Washing Machine Valve with Lever (Straight)
Product Code: DCVI-004



15mm x 3/4" Washing Machine Valve with Lever (Elbow)
Product Code: DCVI-005



15mm x 3/4" Washing Machine Valve with Lever (Tee)
Product Code: DCVI-006



15mm Double Check Valve with Isolator
Product Code: DCVI-001



15mm Isolating Valve with Handle
Product Code: DCVI-002



15mm Isolating "Tee" Valve with Handle
Product Code: DCVI-003

Flow bend clip



DMFit - 10mm Flow Bend Clip
Product Code: AFBC10M

Flush Valve



Flush Valve with Plug (3/8")
Product Code: FV-001

Rigid Elbow



MCM - 1/4" PF x 3/8" NPTF
Product Code: LMA1438G01

MCM - 3/8" PF x 1/4" NPTF
Product Code: LMA3814G01

Tube to Hose Stem

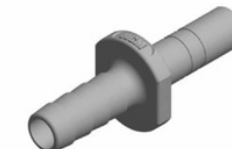

MCM - 1/4" Stem x 1/4" Hose (Straight)
Product Code: SHA1414G01

Collet Clips



1/4" Collet Clip
Product Code: CLIP-001

3/8" Collet Clip
Product Code: CLIP-002

Tube to Hose Elbow



MCM - 1/4" Stem x 1/4" Hose
Product Code: LHA1414G01

Stem Plug



MCM - 1/4" Stem Plug
Product Code: PGA1414G01

MCM - 3/8" Stem Plug
Product Code: PGA3838G01

End Stop (Cap)



MCM - 1/4" Push Fit
Product Code: ESA1414G01

Equal Cross



MCM - 1/4" Push Fit
Product Code: CRA1414G01

Bulkhead Connector



MCM - 1/4" Push Fit
Product Code: BHA1414G01

MCM - 3/8" Push Fit
Product Code: BHA3838G01

Cleaning Materials



10" Hygiene Roll (Box of 18 Rolls)
Product Code: HR-10W-18-001



Poly Cooler Bags
Product Code: PCB-001



3% Peroxide Cooler Sanitisation Spray (100ml)
Product Code: 3HP-001



5% Peroxide in a 1L Dosing Bottle
Product Code: 5HP-001



6% Peroxide in a 5L Bulk Bottle
Product Code: KKKCR5-01



Descaler 5Ltr (30% Acid)
Product Code: KKDESC-01



i-DSCALE Descaling Solution
Product Code: IDS-001

FITTINGS

Cup Dispenser Spares



Flip Top Cover (Black)
Product Code: CD-FTC-B-001



Spare Black Seals + Screws (For Dispensing Head)
Product Code: CD-SS-B-001



Extra Strong Magnetic Fixing Bracket (Black)
Product Code: CD-MB-B-001



Extra Strong Magnetic Fixing Bracket (White)
Product Code: CD-MB-W-001



Plastic Fixing Bracket with Screws (Black)
Product Code: CD-PB-B-001

Flojet



Flojet - BW5003-000A (UK 3 PIN PLUG)
Product Code: FJ001

Install Rail



Mains Water Installation Rail / Kit
Product Code: IR-001

Aquavend Hose



Aquavend 1 Metre of 3/8" (10mm) Hose (3/4" Female Straight x 3/4" Female Elbow)
Product Code: AVH-001

Testing Equipment, Gauges & Meters



50mm Pressure Gauge (0-160 PSI)
Product Code: PG-160-001



50mm Pressure Gauge (0-300PSI)
Product Code: PG-300-001



DigiFlow 8000T
Product Code: WFM-8000T



DigiFlow 6700M
Product Code: WFM-6700M

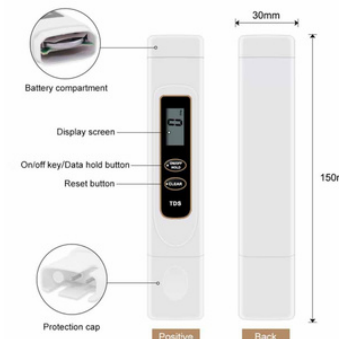

Digital TDS Meter (Water Hardness Tester)
Product Code: TDS-001

Taps



H2O Direct - Tap (Single Lever) Chrome
Product Code: TAP-002



H2O Direct - Tap (Single Push Button)
Product Code: TAP-004



H2O Direct - Tap (Black Lever)
Product Code: TAP-005



Verona Triple Tap (Chrome)
Product Code: VTT3C-001



Fountain Bubbler
Product Code: TAP-006

PERT / LLDPE TUBING

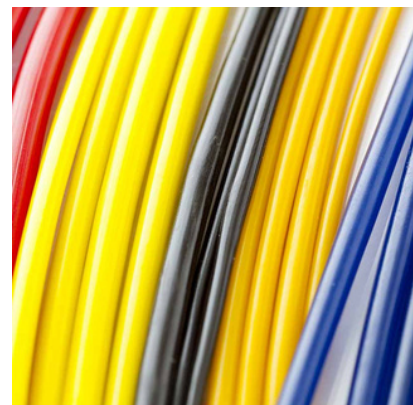

1/4" MCM LLDPE Pipe (300m) (Blue)
Product Code: TBLL14B-01

1/4" MCM PERT Pipe (300m) (White)
Product Code: TBPE14W-01

1/4" MCM LLDPE Pipe (300m) (Black)
Product Code: TBLL14K-01

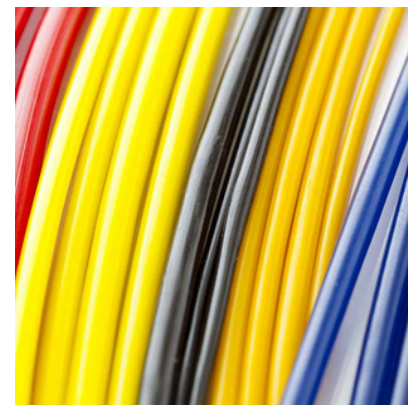

5/16" MCM LLDPE Pipe (200m) (Blue)
Product Code: TBLL15B-01

5/16" MCM LLDPE Pipe (200m) (White)
Product Code: TBLL15W-01

5/16" MCM LLDPE Pipe (200m) (Black)
Product Code: TBLL15K-01

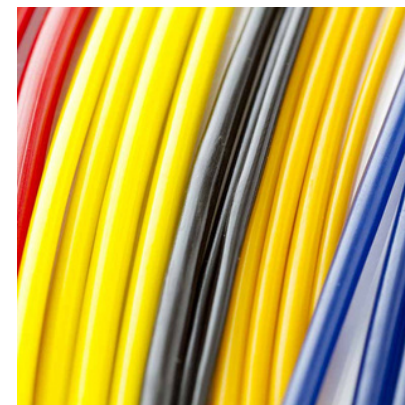

3/8" MCM LLDPE Pipe (200m) (Blue)
Product Code: TBLL38B-01

3/8" MCM LLDPE Pipe (200m) (White)
Product Code: TBLL38W-01

3/8" MCM LLDPE Pipe (200m) (Black)
Product Code: TBLL38K-01



Tube Cutter
Product Code: TC-001

HEADS / STANDS



Head Replacement for the VH-IEN Range of filters



HF Head Complete (IEN / MH)



Support Base for the VH-IEN-9000, VH-IEN-6000, IEN-9000 and the IEN-6000



Replacement Spacer for the IEN-1500 and the IEN-3000 Support Base



Support Base for the IEN-1500 and the IEN-3000

SERVICE + INSTALLATION



i-DSCALE

i-DSCALE descaling solution allows you to fully descale mains fed water coolers, vending, coffee and espresso machines.

It can also be used to fully descale your hot water tanks, faucets, solenoids and pipe feeds without disassembling them.



M9

Service Cartridge

To be used with M9.



VH

Service Cartridge

To be used with VH-IEN.



HF

Service Cartridge

To be used with IEN/MH4

The cartridge allows you to fully descale your hot water tanks, taps, solenoids and pipe feeds without the need to take them apart.

The service cartridge can be filled with the appropriate Descaling solution ' i-DSCALE' and once re-connected into the head, the solution will be pushed around all the areas where descaling wasn't possible before.