

Installation of K3 Inline water filters



*K3 Range
March 10, 2021*

INSTRUCTIONS

There are several types of K3 inline water filters that we produce, they are all the same dimensions so are quite easily interchangeable.

Model	Description	Water Use	Capacity	Dimensions-mm
K3	1 Micron carbon block	Cold	9600L	295-92-102
K3P	1 Micron carbon block with scale inhibitor	Hot/Cold	9600L	295-92-102
K3G	Granulated Activated Carbon	Low Pressure	9600L	295-92-102
K3B	K3 Filter Bracket			

We added the K3G filters to our inline range in 2020 to provide filtered water for low pressure water fed machines that are needed occasionally.

Installation.

1. Turn off the cold-water supply.
2. Locate an easily accessible location or section of tubing where you want to install the filter.
3. Cut the tubing using a tube cutter – ensure that the edges of the cut tube are clean and free from sharp edges or burrs (use steel wool or a file if required on copper tubing). Do not cut tubing on an **angle** as this may cause the unit to leak during service. See figure 3. Remove protective film from filter & Remove red clip from both ends of filter.



4. **NOTE:** There is a directional flow arrow on the filter. The incoming water should be routed to the inlet and the filtered water should be coming from the outlet or arrowhead end of the flow arrow. Figure 1. There is also a mount bracket available – see K3 Filter Bracket below.

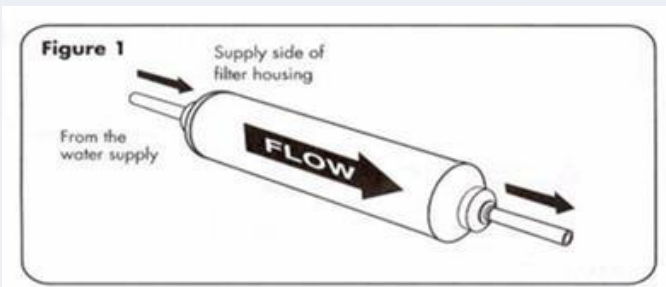

K3 Filter Bracket

5. Insert the water supply tubing (1/4" plastic) into the end of the filter. Push firmly until the tubing bottoms out. Attach the red safety collet ring (Figure 2).
6. Hold the filter over a bucket or other suitable container and Turn on the water supply, flush filter thoroughly until the water runs clear.
7. Turn water off
8. Insert outlet tubing (1/4" plastic) into the other end of the filter. Push firmly until the tubing bottoms out, making sure to install the outlet tubing firmly and until it bottoms out in the fitting. Attach the red safety collet ring (Figure 2).
9. Turn the water supply back on and check immediately for leaks.

Important: The operational, maintenance and replacement requirements must be followed for this unit to perform as sold.

Replacement:

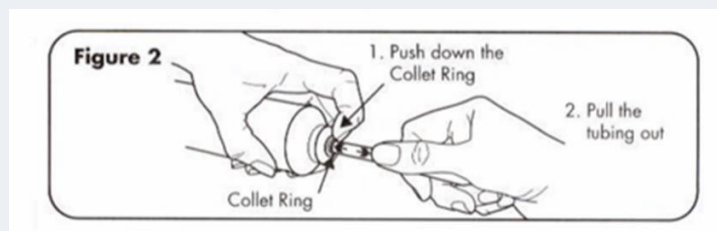

Figure 3



1. Turn off the cold-water supply.
2. Remove the red safety Collet clips from either end of filter.
3. Remove the tubing from the ends of the filter
See figure 2 above for using the built in quick connect fittings -1
4. Trim off a short section(5-10mm) of tubing on both ends using a tube cutter
See figure 3.
5. Insert supply tubing (1/4" plastic) into the end of the filter. Push firmly until the tubing bottoms out.

6. Turn on the water supply. Hold the filter over a bucket or other suitable container and flush until the water runs clear.
7. Turn water off
8. Repeat step 5 for the outlet side of the filter, making sure to install the tubing firmly and until it bottoms out in the fitting.
9. Turn the water supply back on and check immediately for leaks.

Install this filter on cold water only. Do not use on water lines exceeding 100°F (38°). Water pressure minimum is 20psi and the Maximum is 125psi. Please note that all pipework should always be fitted with a Pressure Limiting Valve.

- Intended for indoor use only.
- For extended periods of non-use, turn water off and dispose of filter. Replace with new filter prior to turning back on water supply.
- Tubing and hose dimensions are ¼"
- Before using the water, flush the new filter for until clear.
- Change the cartridge at manufacturers suggested interval or sooner if you notice a change in taste, odor or color of the water or low water pressure.
- It is advised that this operation is carried out by an experienced engineer or qualified plumber.
- All filters in water coolers should be fitted as in accordance with the recommendations of Watercoolers Europe or The Water Hydration Association (UK) Guidelines. This includes fitting a pressure reducer (PRV) and Water Block, prior to any installation.
- Information in this leaflet is for guidance only and H2O Direct take no responsibility for installation. Please consult with professional engineers.

Tools & Fittings that may be needed on installation or replacements:

- | |
|--|
| • Container for flushing the filters |
| • Filter |
| • ¼" Tubing |
| • ¼" Isolator |
| • Water Block and Reset Adaptor / Install Rail |
| • PRV (if not using Install Rail) |
| • Tube Cutter |
| • Gloves |
| • K3 Bracket |

Approvals and Certifications.



NSF42 Certified



BS 6920-1:2014 Certified



Meets and exceeds certification for:

Europe



Germany



Belgium/Holland



Spain



France

“EU guidelines for Good Hygienic Practice for Distributors and operators of Plumbed-in POU (Point of Use) Water Coolers issued by Watercoolers Europe, pursuant to Article 9 of Regulation (EC) NO 852/2004 of the European Parliament” section 6.7 The type of water filters installed must be adapted to the local circumstances (e.g. the water quality) and be certified with the minimum NSF Standard 42 Class 1 or any equivalent European Standard.

For more information please feel free to contact us:

Jim Redford

Email: jim.redford@h2odirect.co.uk

Mobile : +44(0) 7968894355

Office: +44 (0) 1892669628